

2 x 6 Exterior Wall Framing for:
15-0 x 8-0 Western Pocket Slider*
177 1/2" x 96" Slider Rough Opening
Triple 1 3/4" x 18" x 183 1/2" LVL Header

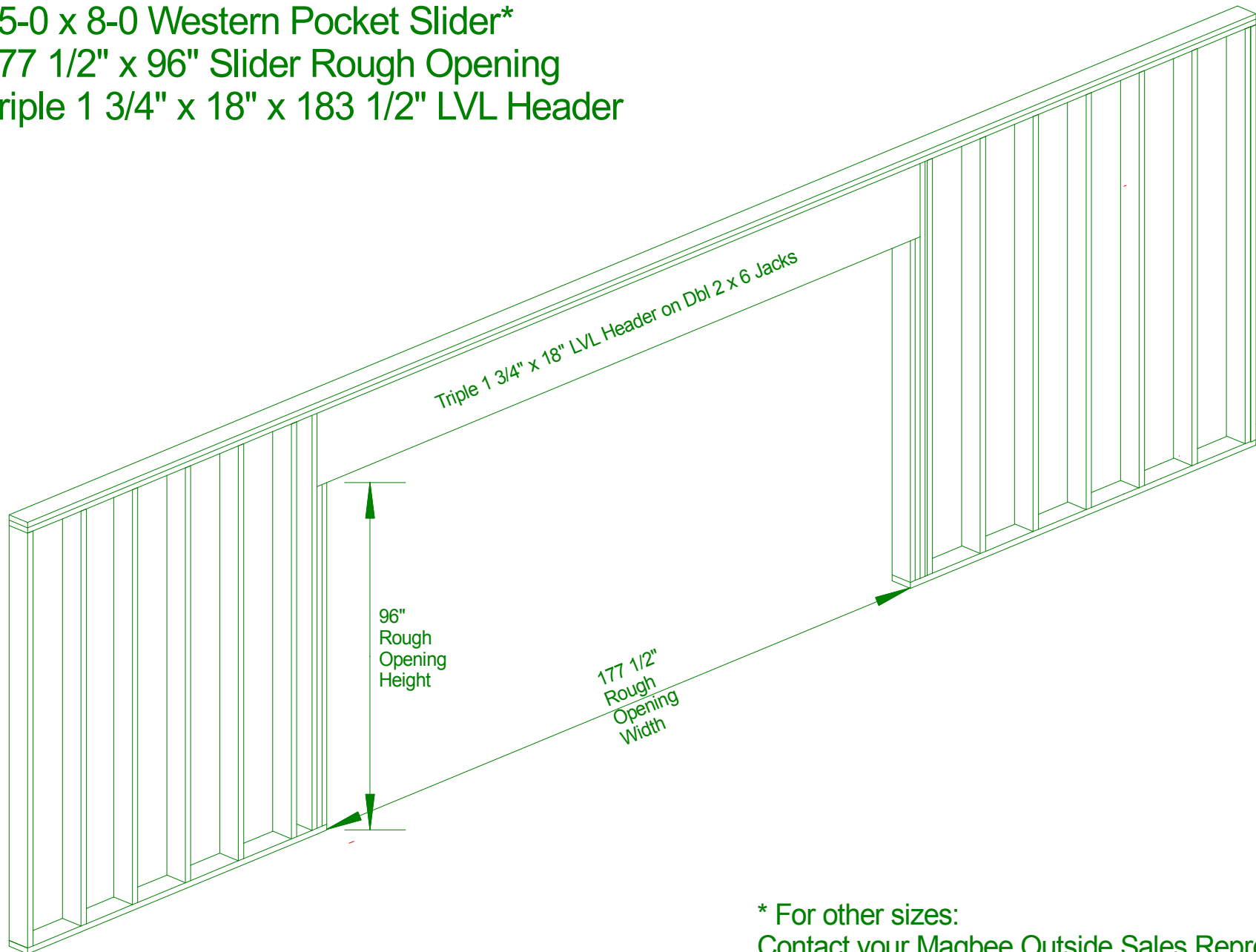

* For other sizes:
Contact your Magbee Outside Sales Representative
for Rough Openings and Specification Details
prior to framing

Slider Pocket Jamb

242 1/2" x 96" Rough Opening

Dbl. 1 1/2" x 8 1/4" x 96" PT Jamb Legs

Single 1 1/2" x 10 1/4" x 248 1/2" Jamb Head

1 1/2" x 10 1/4" x 248 1/2" Jamb Head
on Dbl 1 1/2" x 8 1/4" Jacks

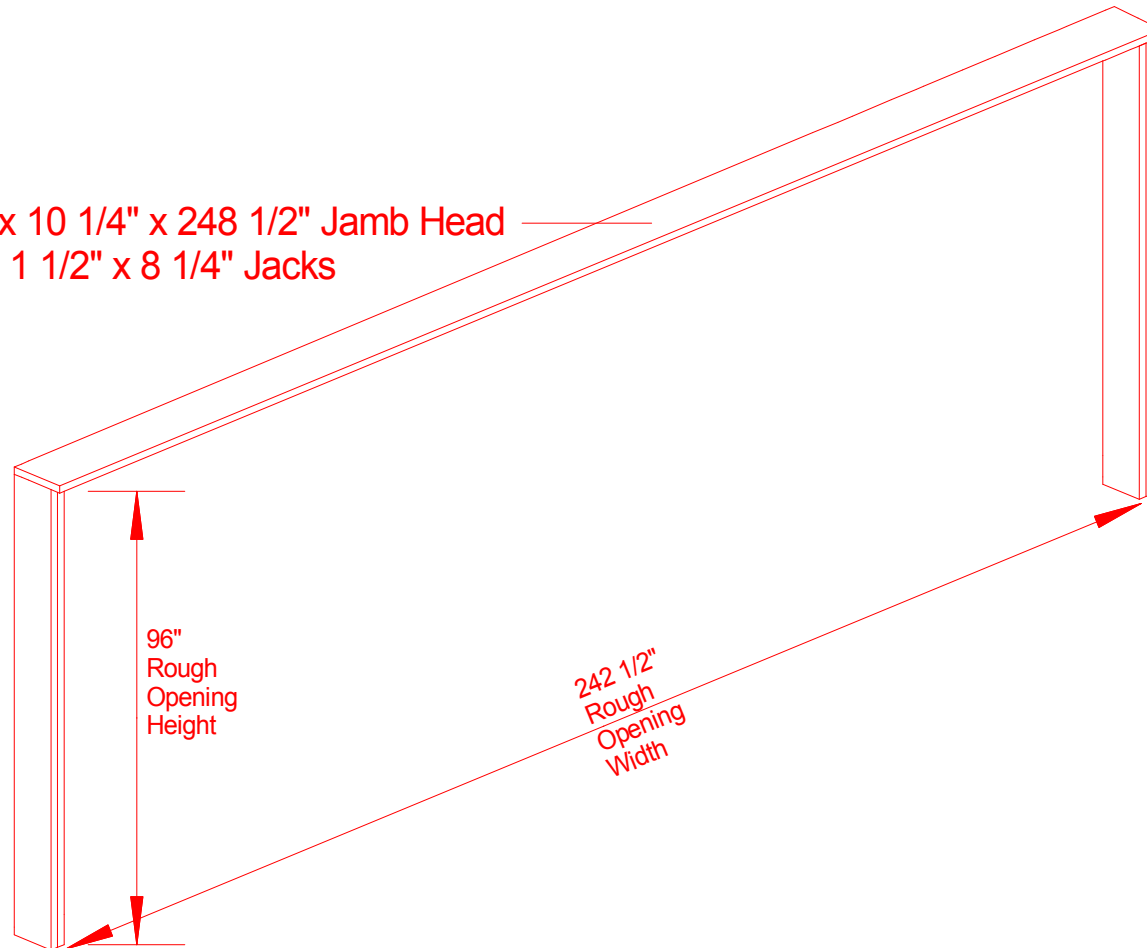

2 x 4 Interior Wall
177 1/2" x 96" Slider Rough Opening
Single 1 3/4" x 18" x 183 1/2" LVL Header

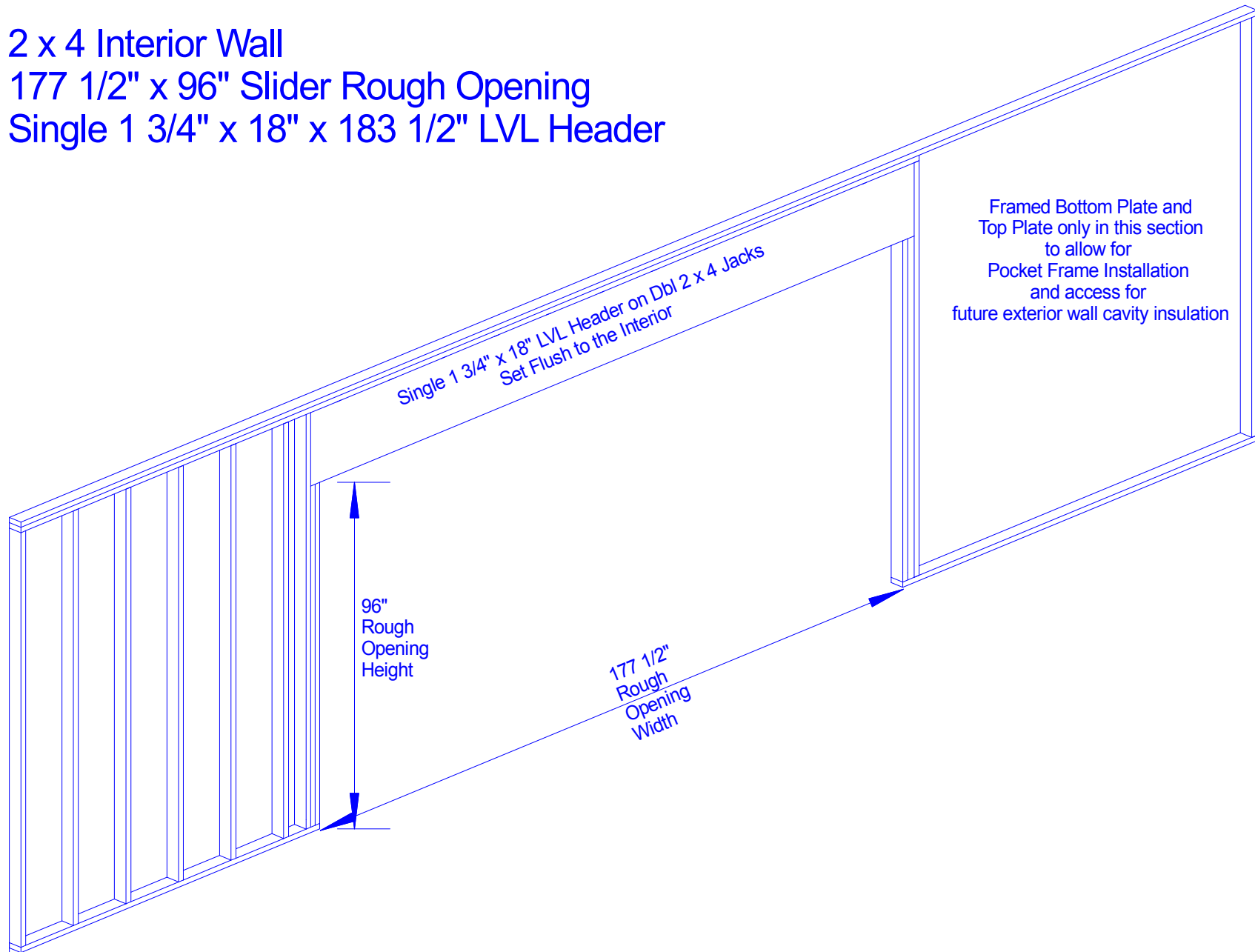

2 x 4 Interior Wall
177 1/2" x 96" Slider Rough Opening
Single 1 3/4" x 18" x 183 1/2" LVL Header

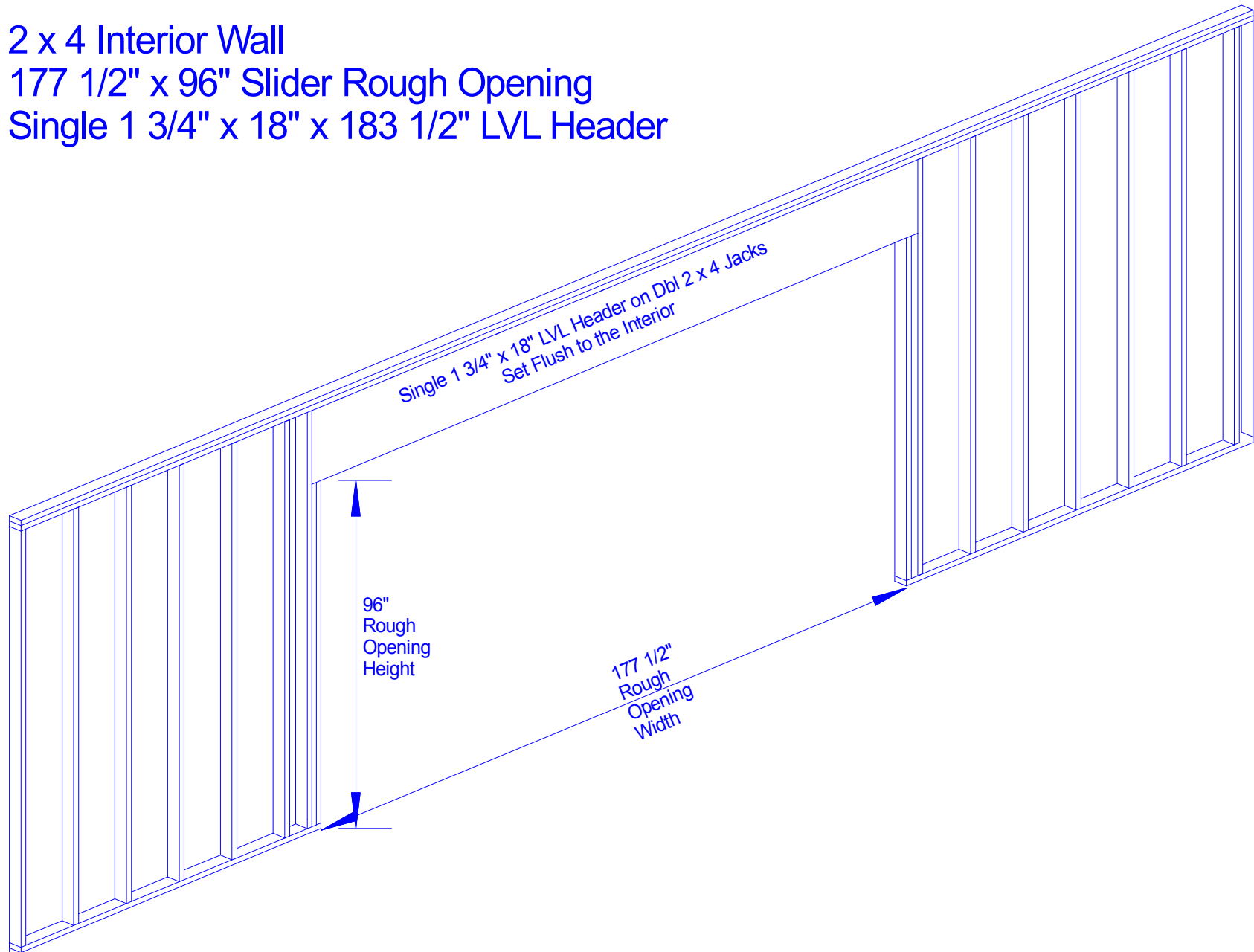

Step #1 Exterior Wall Installation

Install the exterior wall in position per plan

Confirm header sizing per loading capacity

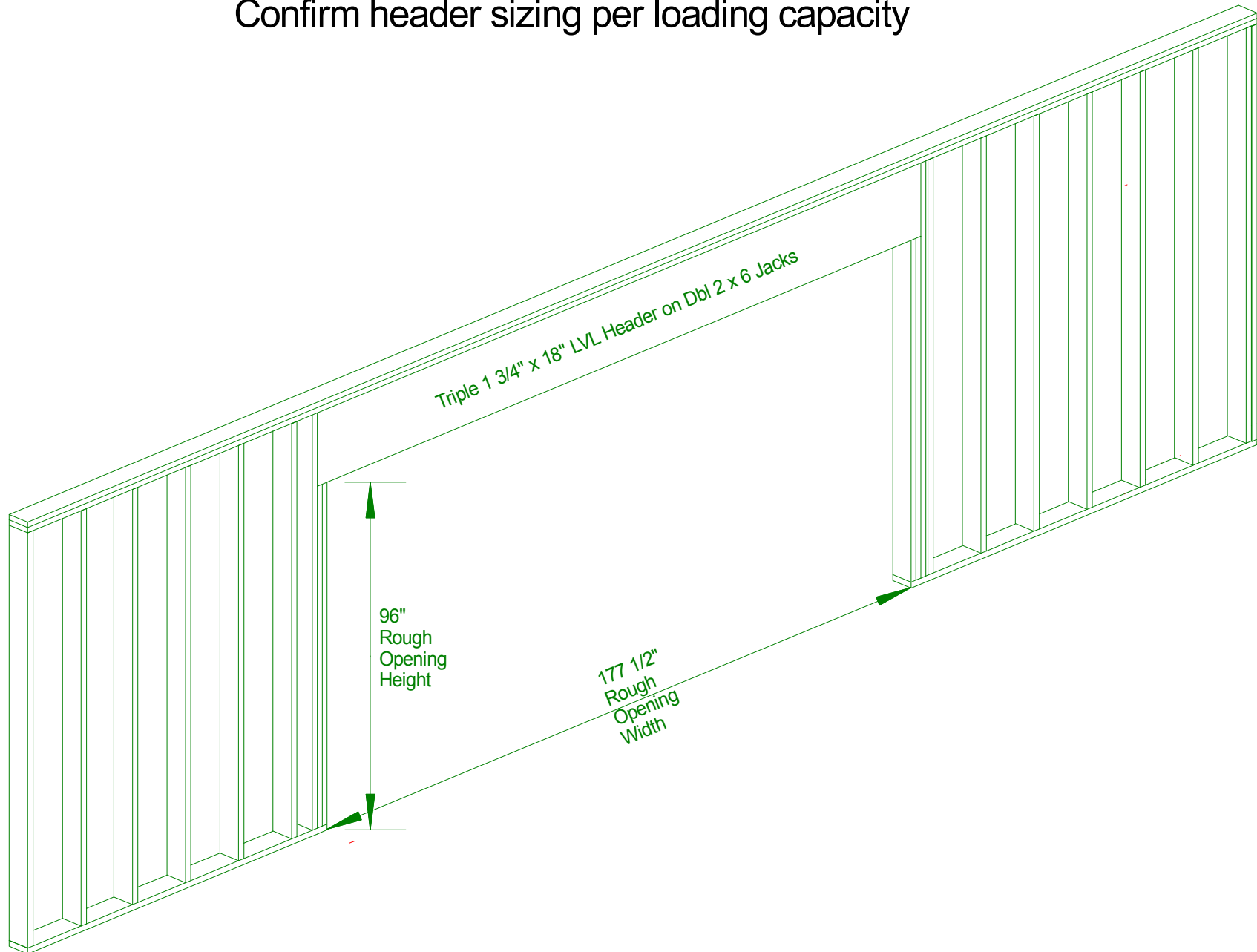

Step #2 Pocket Slider Jamb Installation

Installed so the rough opening of the pocket jamb and the rough opening of the exterior wall line up with each other on the strike side.

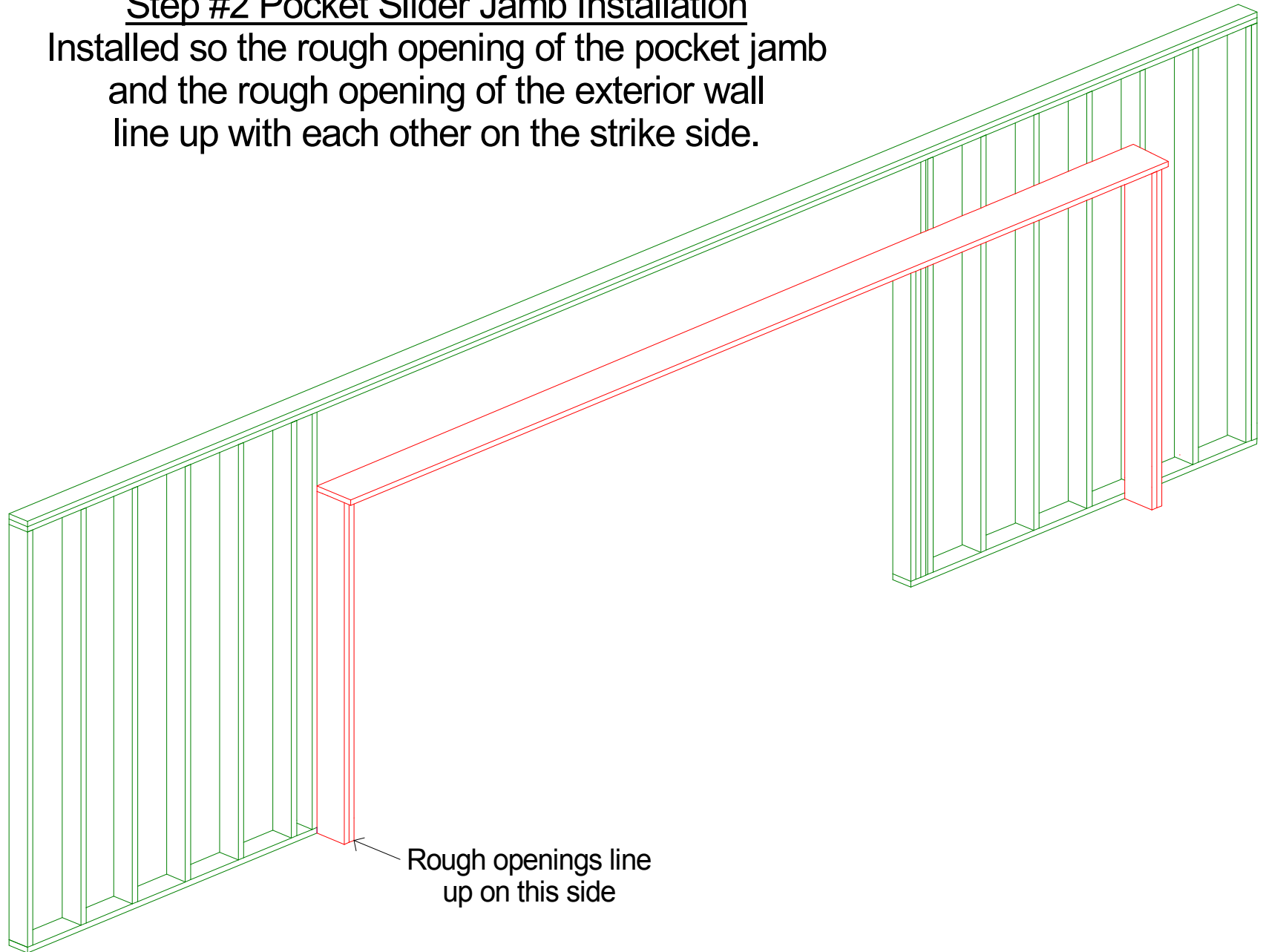

Step #3 Interior Wall Installation

Installed the 2 x 4 Interior wall
so the rough openings of all 3 walls
line up with each other on the strike side.

1 3/4" of the pocket frame head jamb
will bear on the interior rough opening jacks.
The head jamb will be secured by face nailing
through the interior LVL header and toenailing into
the exterior LVL header. See section drawing.

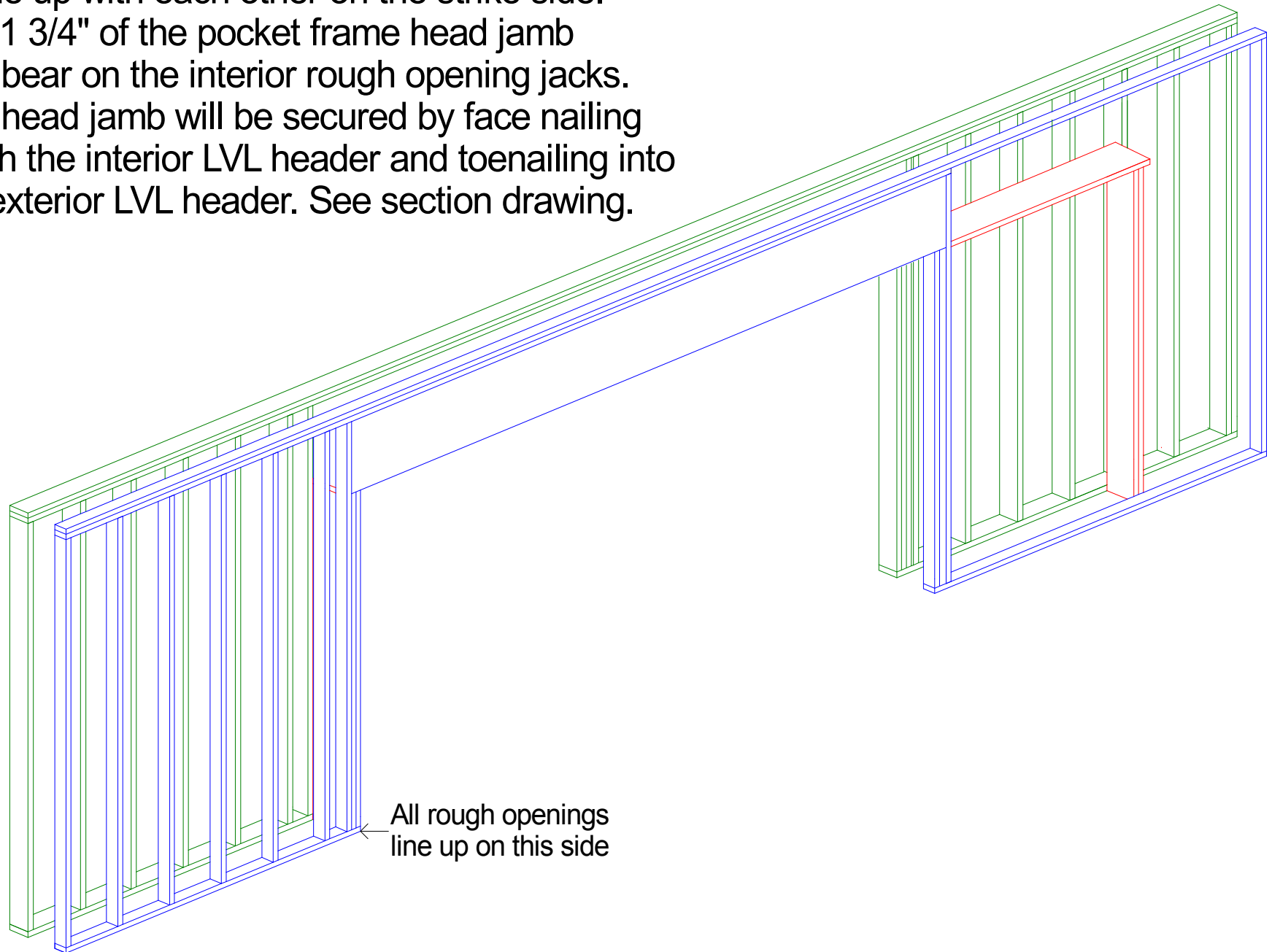

Step #4 Final Framing Layout
Interior Wall is completed after
all walls that require insulation
have been sealed.

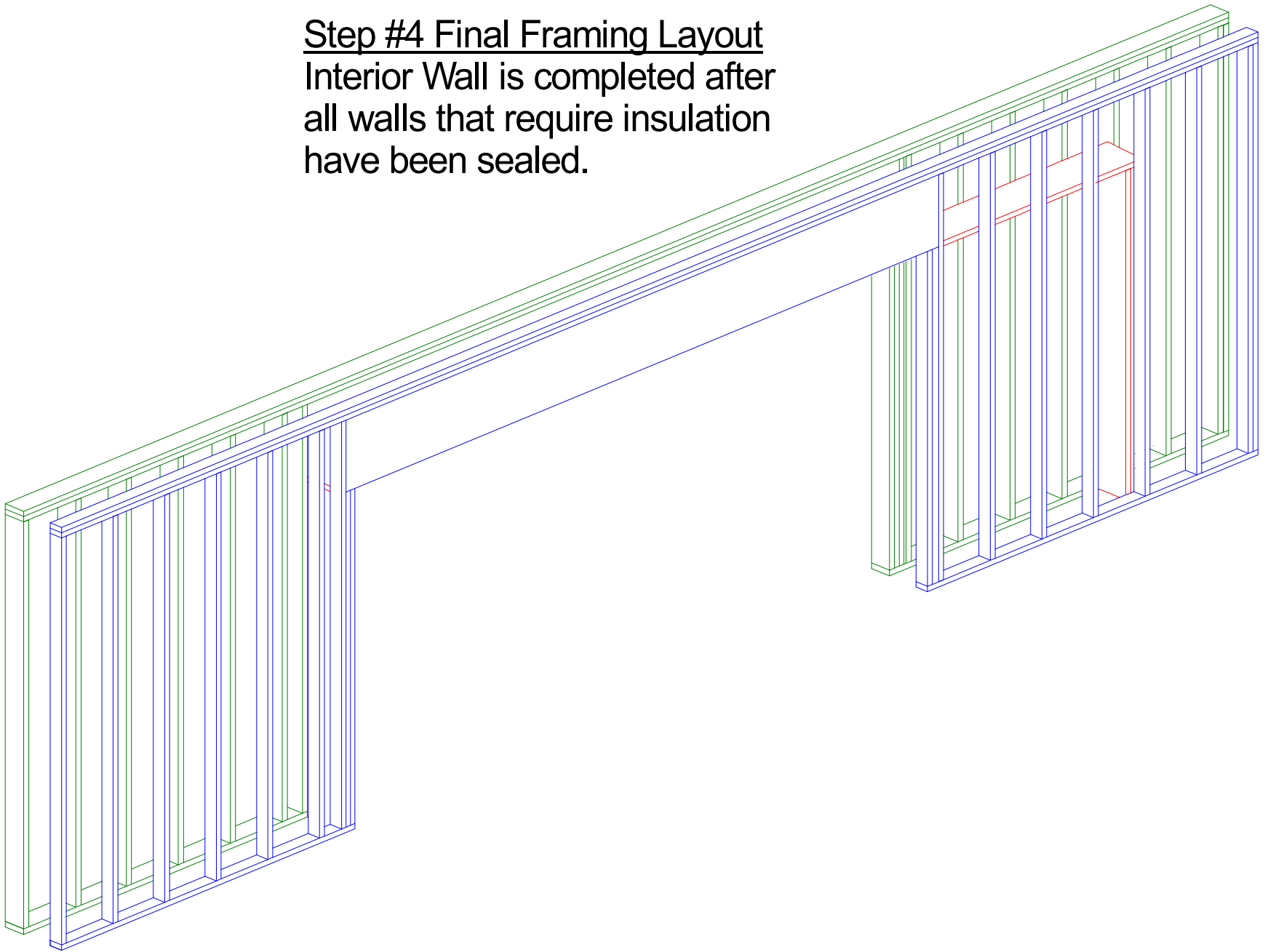

Wall Section at Strike End

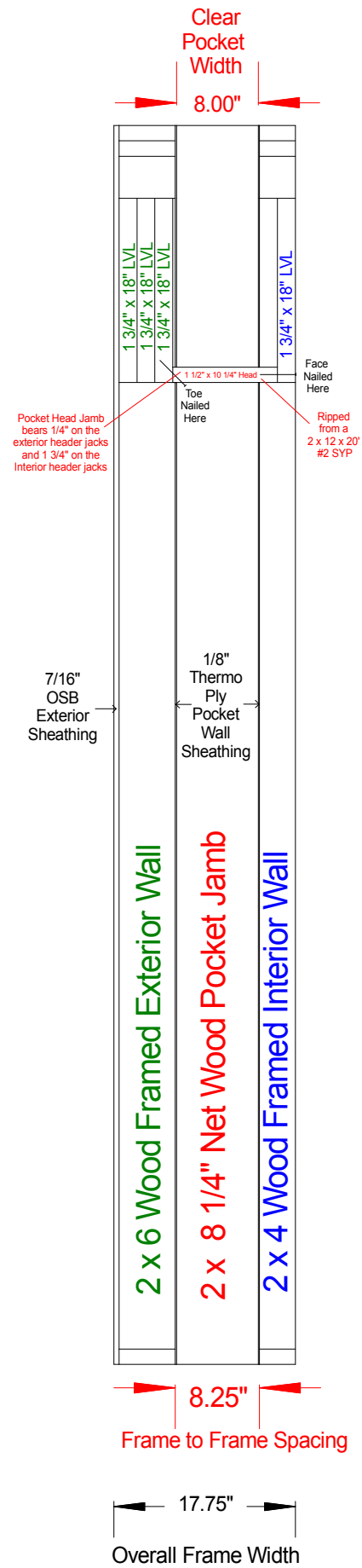

Wall Section at Pocket End

